

Crimson Fire, Inc.
SE Series Pumper
City of Buckley Fire Department, WA



TECHNICAL SPECS

Sold by:



**H&W Emergency
Vehicles, Inc.**

www.hwev.com

DELIVERY DATE

- May 2008

TRUCK

- 07073

SERIES

- SE Series

MODEL

- Pumper

CHASSIS

- Spartan Advantage
- Cummins ISC 330HP

BODY MATERIAL

- Aluminum

PUMP

- Hale QMAX 1500
- Top Mount Control
- 750 Gallon Poly Tank

GENERATOR

- Outback Inverter 2500wt



CRIMSON FIRE

A Spartan Company

ABOVE AND BEYOND

www.crimson-fire.com

Crimson Fire, Inc.

SE Series Pumper

City of Buckley Fire Department, WA

NOTE: DIMENSIONS FOR GENERAL INFO. CONSTRUCTION SHALL BE ONLY ON UNLESS OTHERWISE SPECIFIED. DIMENSIONS ASSOCIATED WITH THESE ITEMS ARE ESTIMATES AND MAY VARY WITH FINAL PRODUCTION. INCLUDING SURFACE HEIGHT AND LENGTH. ALL OTHER ITEMS SUCH AS LIGHTS, BATTERIES, AND WHEELS ARE TO BE ORDERED SEPARATELY AND MAY NOT BE A DIRECT REFLECTION OF THE SPECIFICATIONS. IN ALL SITUATIONS, THE DRAWING MAY CONTRADICT THE SPECIFICATIONS. THE SPECIFICATIONS SHALL BE THE LATEST NFPA RECOMMENDATIONS UNLESS OTHERWISE SPECIFIED. CRIMSON FIRE WILL ENGINEER AND MANUFACTURE THE PRODUCT TO THE INTENT OF THE SPECIFICATIONS AND NOT BE RESPONSIBLE FOR ANY DIMENSIONAL VARIATIONS OR CHANGES WITHOUT NOTICE.

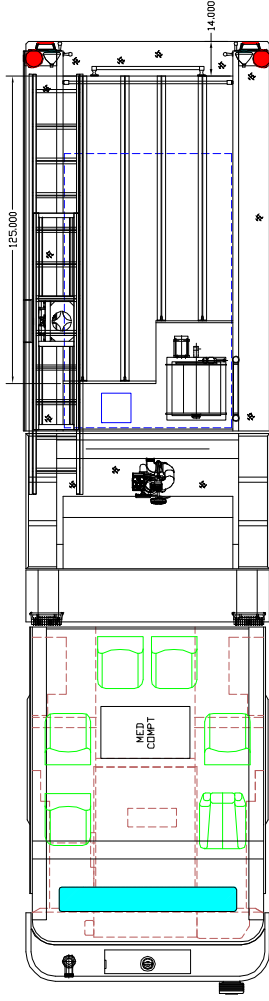

TOP CONTROL PANEL LAYOUT

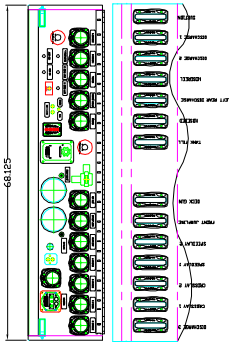

RECESS DECK GUN AS FAR AS POSSIBLE

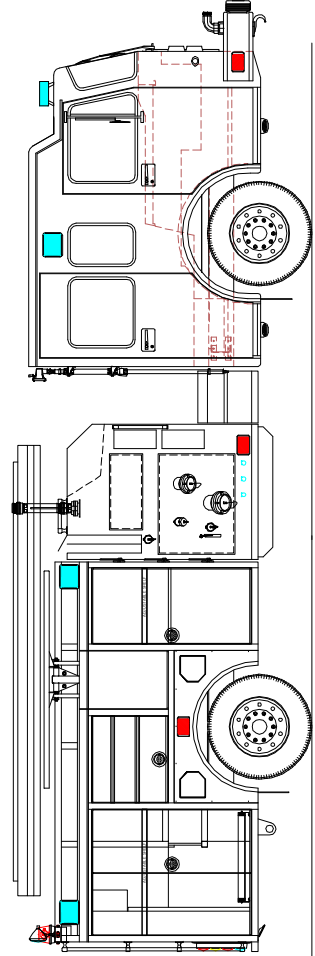
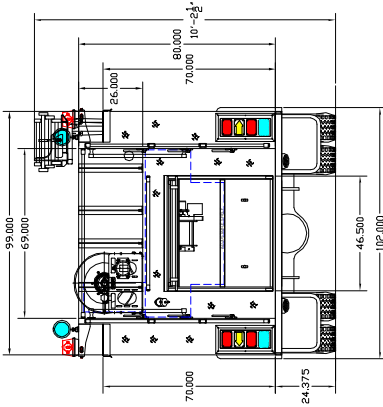
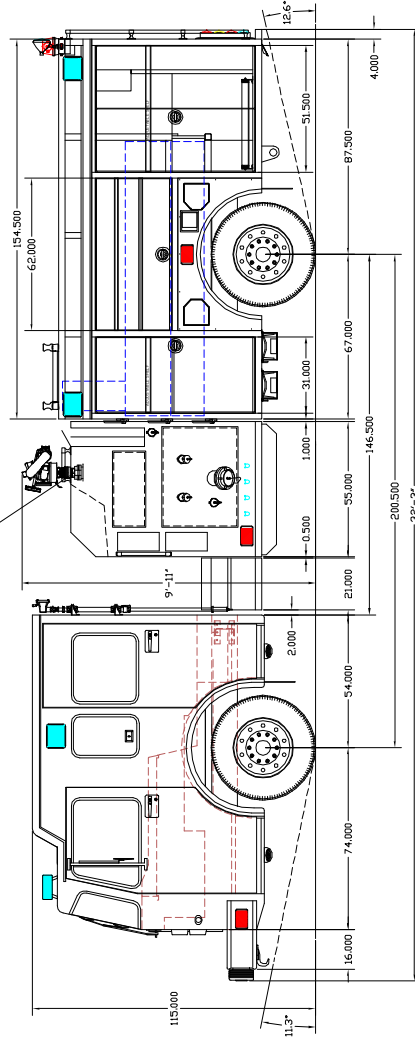

PROPRIETARY AND CONFIDENTIAL

THE INFORMATION CONTAINED IN THIS DRAWING IS THE SOLE PROPERTY OF CRIMSON FIRE. ANY REPRODUCTION IN PART OR AS A WHOLE WITHOUT THE WRITTEN PERMISSION OF CRIMSON FIRE IS PROHIBITED.

LENGTH	WIDTH	HEIGHT	ABOVE HOODS	UNDER CODE	PALETTE CODE	DATE	BY	CHK	APP	DESCRIPTION

TOLERANCE UNLESS OTHERWISE SPECIFIED
 DIMENSIONS IN PARENTS/AS POSSIBLE/FEET/INCHES
 ANGLES: 2°
 RISE PARTS: 40:60

07073 BUCKLEY

DRAWING NUMBER



REVISION SHEET

4 2